

Square Anchor

Installation Instructions

Parts Needed

- A** Square Anchor
- B** NEX® Post
- C** Wedge™

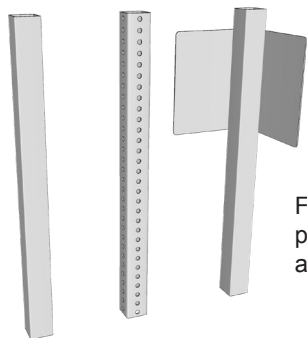
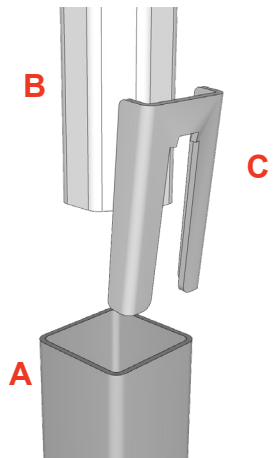

For use with square plain, perforated and winged anchors.

Tools Recommended*

- D** Easy Driver, Sledge Hammer or Power Driver
- E** Drive Cap (manual or power)
- F** Hammer

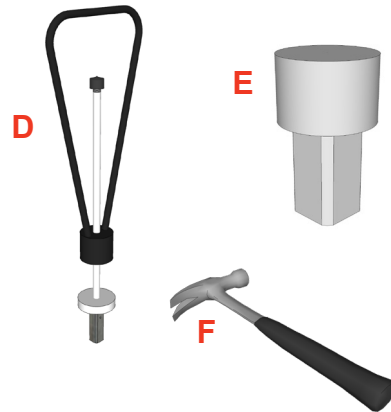

Installation Steps

1 Install Anchor
Place the Drive Cap in the opening of the anchor. Use a power driver or sledge hammer to drive the anchor into the ground in desired location.

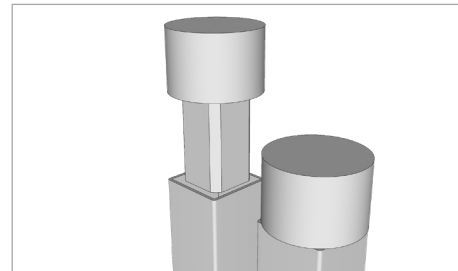

When the anchor is flush with the ground, or no more than two (2") inches above the ground, remove the Drive Cap.

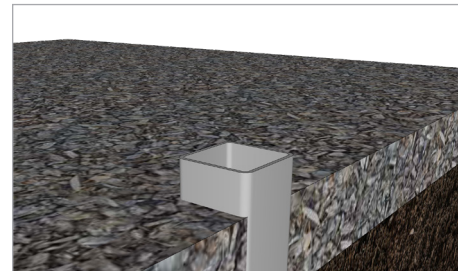

2 Secure the Post
Place the NEX Post into the anchor approximately six (6") inches. Insert the NEX Wedge between the anchor and the post.

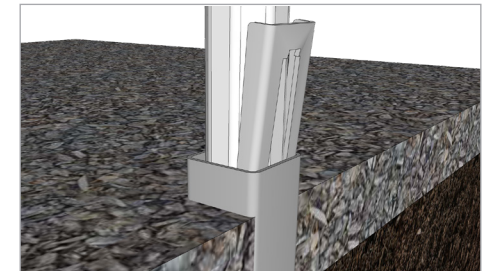

Use a hammer to secure the Wedge until well seated.

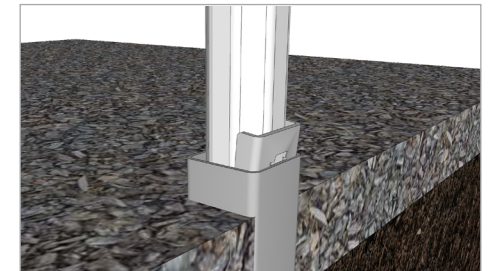

* Sold separately.